

CCMC 13101-R

CCMC Canadian code compliance evaluation

CCMC number:	13101-R
Status:	Active
Issue date:	2003-02-06
Modified date:	2023-11-08
Evaluation holder:	<p>Plasti-Fab Ltd.</p> <p>300 - 2891 Sunridge Way NE Calgary AB T1Y 7K7 Canada</p> <p>Website: www.plastifab.com Telephone: 403-569-4312 Email: jwhalen@plastifab.com</p>
Product name:	Advantage Insulating Concrete Forming (ICF) System
Compliance:	NBC 2015
Criteria:	CCMC-TG-031119.01-15A, "CCMC Technical Guide for Modular, Expanded-Polystyrene Concrete Forms"

In most jurisdictions this document is sufficient evidence for approval by Canadian authorities.
[Learn more about CCMC recognition](#) [Look for the trusted CCMC mark on products to verify compliance.](#)

Compliance opinion

It is the opinion of the Canadian Construction Materials Centre that the evaluated product, when used as an insulated concrete form in accordance with the conditions and limitations stated in this evaluation, complies with the following code:

National Building Code of Canada 2015

Code provision	Solution type
4.1. Structural Loads and Procedures	<u>Acceptable</u>
4.1.1.3.(4)(c) CAN/CSA-S269.3-M, "Concrete Formwork."	<u>Alternative</u>
4.3.3. Plain, Reinforced and Pre-stressed Concrete	<u>Acceptable</u>
9.3.1.1. General	<u>Acceptable</u>
9.15.1.1.(1)(c) Flat insulating concrete form ...	<u>Acceptable</u>
9.15.3.3. Application of Footing Width and Area Requirements	<u>Acceptable</u>
9.15.3.5.(1)(c) 150 mm for each storey ...	<u>Acceptable</u>
9.15.4.1.(1) Insulating concrete form units shall be ...	<u>Acceptable</u>
9.15.4.2. Foundation Wall Thickness and Required Lateral Support	<u>Acceptable</u>
9.15.4.3.(5) Flat insulating concrete form foundation ...	<u>Acceptable</u>
9.15.4.4. Foundation Walls Considered to be Laterally Supported at the Bottom	<u>Acceptable</u>
9.15.4.5. Reinforcement for Flat Insulating Concrete Form Foundation Walls	<u>Acceptable</u>
9.20.1.1.(2) For walls other than those described in ...	<u>Acceptable</u>
9.20.1.1.(1)(b) flat insulating concrete form ...	<u>Acceptable</u>
9.20.15.1. Amount of Reinforcement	<u>Acceptable</u>
9.20.17. Above-Ground Flat Insulating Concrete Form Walls	<u>Acceptable</u>

The above opinion(s) is/are based on the evaluation by the CCMC of technical evidence provided by the evaluation holder, and is bound by the stated conditions and limitations. For the benefit of the user, a summary of the technical information that forms the basis of this evaluation has been included.

Product information

Product name

Advantage Insulating Concrete Forming (ICF) System

Product description

The product is a modular, interlocking concrete form system consisting of 2 expanded polystyrene panels. Embedded in the polystyrene panels are polypropylene connectors that are equally spaced at 203 mm horizontally for the 150-mm-thick concrete wall form and 152 mm horizontally for the 200-mm-thick concrete wall form.

The polystyrene face panels have a preformed symmetrical interlocking expanded polystyrene (EPS) design along the top, bottom and vertical edges to facilitate stacking and alignment, as well as to prevent leakage of freshly placed concrete.

The units are dry-laid and stacked in a running (staggered) configuration. The stacked units form a rectangular space that, after being filled with concrete, results in an insulated, monolithic concrete wall of uniform thickness. Reinforcement may be placed where required to satisfy strength requirements for above- or below-grade load bearing walls, beams, lintels and shear walls.

The units have external dimensions of 1 219 mm in length and 419 mm in height. The polystyrene panels are each 67 mm thick, resulting in an overall wall thickness of 284 mm for the 150-mm-thick concrete wall form or 334 mm for the 200-mm-thick concrete wall form.

The product units are available in straight, 90° or 45° corner forms, Taper Top Block and Brick Ledge Block forms. A standard unit is illustrated in the Figure below.

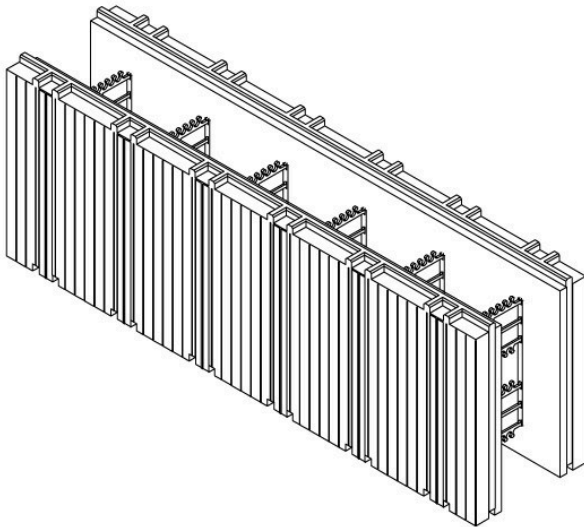

Figure 1. Advantage Insulating Concrete Forming (ICF) System standard unit

Manufacturing plant

This evaluation is valid only for products produced at the following plant:

This PDF is an alternative version. This document was published on 2024-02-29 and may not be the latest version of this evaluation. Users should consult the latest [published assessment](#) on the [CCMC Registry of Product Assessments](#), which contains the most up to date information. This PDF is intended for use as a record, not the latest information available.

Product name	Manufacturing plant
	Crossfield, AB, CA
Advantage Insulating Concrete Forming (ICF) System	☑

☑ Indicates that the product from this manufacturing facility has been evaluated by the CCMC

Conditions and limitations

The CCMC's compliance opinion is bound by this product being used in accordance with the conditions and limitations set out below.

- The product is permitted to be used in the construction of houses and small buildings up to 2 storeys above grade and 1 storey below grade that fall under the provisions of Part 9, Housing and Small Buildings, of Division B of the NBC 2015. It is subject to all of the conditions listed below.
- The structural applications of this product must be in strict accordance with the design analysis as prepared by Plasti-Fab Ltd., Report No. 19-02-01, dated February 01, 2019, from which [Table 1](#) to [Table 18](#) have been reproduced. When the product is used in structural applications outside the scope of the referenced design analysis, the engineering design analysis, related documents and drawings must bear the authorized seal of a registered professional engineer skilled in concrete design and licensed to practice under the appropriate provincial or territorial legislation. The engineer must certify that the construction provides a level of performance equivalent to that required by Part 4, Structural Design, and/or Part 9 of the NBC 2015.
- The maximum permitted building length is 24.4 m and the maximum permitted building width is 12.2 m. Engineering is required on a case-by-case basis for buildings that exceed these dimensions.
- For loadbearing wall and shear wall applications, the minimum core thickness of the product must be 150 mm.
- For non-loadbearing wall applications, the minimum core thickness of the product must be 100 mm.
- Concrete used with this system must comply with Subsection 9.3.1. of Division B of the NBC 2015. It must be Type GU (General Use), with a minimum compressive strength of 20 MPa and a maximum slump of 150 ± 12 mm.
- The maximum aggregate size to be used in conjunction with this product must be no greater than 19 mm.
- For the wall heights indicated in [Table 1](#) and Table 2, the pouring of concrete must be made at a rate of 1.3 m per hour in consecutive lifts. Each lift is limited to a maximum height of 1.3 m.
- All point loads, such as concentrated loads created by girder trusses, columns and beams, must bear directly on top of the concrete wall and must not be supported in any manner that would create an eccentric loading on the concrete wall.
- Floor and roof connections to ICF walls must be designed to accommodate diaphragm action in seismic zones and zones of high wind pressure.
- The concrete must be cured a minimum of 7 days before backfilling. The wall must be laterally supported at the top and bottom prior to backfilling.
- The EPS insulation used in this system must comply, at minimum, with CAN/ULC-S701-11, "Thermal Insulation, Polystyrene, Boards and Pipe Covering," Type 2.
- The product's EPS insulation panels must be aged for at least 3 weeks from their date of manufacture.
- The concrete wall must be constructed on a footing designed as per Article 9.15.3.4., Basic Footing Widths and Areas, of Division B of the NBC 2015.
- The attachment of exterior cladding and interior finishing materials has not been assessed by the present evaluation.
- The interior face of the EPS panels must be protected from the inside of the building in accordance with Sentence 9.10.17.10.(1), Protection of Foamed Plastics, of Division B of the NBC 2015.
- For above-grade installations, the exterior face of the product must be protected with materials conforming to Article 9.20.6.4., Masonry Veneer, and Sections 9.27., Cladding, and/or 9.28., Stucco, of Division B of the NBC 2015.
- For below-grade installations, dampproofing must be provided in accordance with Article 9.13.2., Dampproofing, of Division B of the NBC 2015.
- Where hydrostatic pressure exists, waterproofing must be provided in accordance with Article 9.13.3., Waterproofing, of Division B of the NBC 2015.

For foundation wall installations, the backfill must be placed in such a way as to avoid damaging the wall, the exterior insulation panel and the waterproofing and dampproofing protection. The backfill material must be well-drained and a drainage system must be installed around the footing in accordance with the requirements of the NBC 2015. The installation of the product must be in strict compliance with the Advantage ICF Installation Manual dated October 3, 2018, without conflicting with the requirements stated in the NBC 2015 or this Report. Only installers trained and authorized by Plasti-Fab Ltd. shall be contracted to set up the wall system.

This PDF is an alternative version. This document was published on 2024-02-29 and may not be the latest version of this evaluation. Users should consult the latest [published assessment](#) on the [CCMC Registry of Product Assessments](#), which contains the most up to date information. This PDF is intended for use as a record, not the latest information available.

Technical information

This evaluation is based on demonstrated conformance with the following criteria:

Criteria number	Criteria name
CCMC-TG-031119.01-15A	CCMC Technical Guide for Modular, Expanded-Polystyrene Concrete Forms

Material requirements

Compliance of the expanded polystyrene thermal insulation with the requirements of CAN/ULC-S701-11 is covered under Intertek Testing Services (NA) Ltd. Certificate and/or Label service.

Design requirements

The design analysis in the Engineering Analysis Report of walls using the product was provided to CCMC. It provides a level of performance equivalent to that required by applicable provisions in Part 4 and/or Part 9 of Division B of the NBC 2015. The corresponding design analysis is summarized in the tables below. The tables provide steel reinforcement specifications for a number of different wall and lintel applications based on specific structural loads. The design assumptions are indicated below each table.

Table 1. Vertical and horizontal steel reinforcement for below-grade walls ⁽¹⁾ ⁽²⁾

Wall height (m)	Backfill height (m)	Max. spacing for vertical reinforcement (mm)		Max. spacing for horizontal reinforcement (mm)	
		150-mm wall	200-mm wall	150-mm wall	200-mm wall
2.44	1.22	10M @ 406	10M @ 305	10M @ 419	15M @ 419
	1.52	10M @ 406	10M @ 305	10M @ 419	15M @ 419
	1.83	10M @ 305	10M @ 305	10M @ 419	15M @ 419
	2.13	10M @ 203	10M @ 305	10M @ 419	15M @ 419
3.05	1.22	10M @ 406	10M @ 305	10M @ 419	15M @ 419
	1.52	10M @ 406	10M @ 305	10M @ 419	15M @ 419
	1.83	10M @ 305	10M @ 305	10M @ 419	15M @ 419
	2.13	10M @ 203	10M @ 305	10M @ 419	15M @ 419
	2.44	15M @ 305	15M @ 457	10M @ 419	15M @ 419
	2.74	15M @ 203	15M @ 305	10M @ 419	15M @ 419
3.66	1.22	10M @ 406	10M @ 305	10M @ 419	15M @ 419
	1.52	10M @ 406	10M @ 305	10M @ 419	15M @ 419
	1.83	10M @ 305	10M @ 305	10M @ 419	15M @ 419
	2.13	10M @ 203	10M @ 305	10M @ 419	15M @ 419
	2.44	15M @ 305	15M @ 457	10M @ 419	15M @ 419
	2.74	15M @ 203	15M @ 305	10M @ 419	15M @ 419
	3.05	–	15M @ 203	–	15M @ 419
	3.35	–	15M @ 203	–	15M @ 419

This PDF is an alternative version. This document was published on 2024-02-29 and may not be the latest version of this evaluation. Users should consult the latest [published assessment](#) on the [CCMC Registry of Product Assessments](#), which contains the most up to date information. This PDF is intended for use as a record, not the latest information available.

Notes

- 1 The "Vertical and horizontal steel reinforcement for below-grade walls" table is based on the following assumptions:
- The design is applicable to all seismic zones.
 - The maximum building width is 12.2 m.
 - The maximum building length is 24.4 m.
 - The maximum floor clear span is 6.1 m.
 - The maximum roof clear span is 12.2 m with supports at mid-point.
 - The maximum number of stories above grade is 2.
 - The maximum number of stories below grade is 1.
 - The roof slope from flat to maximum 1:1.
 - The roof dead load is 0.72 kPa.
 - The floor dead load is 1.2 kPa.
 - The floor live load is 1.92 kPa.
 - The snow load is 4.44 kPa.
 - The surcharge load is 2.4 kPa.
 - The loads include earth pressure and surcharge loads, plus gravity load. The gravity load assumes 2 ICF storeys and a wood roof frame.
 - Below-grade walls are assumed to support a brick veneer with a maximum height of 7 320 mm, with an eccentricity of 220 mm for the 150-mm-thick wall system and 245 mm for the 200-mm-thick wall system.
 - The design earth pressure is 960 kg/m³ (equivalent fluid density).
 - All above-grade walls are assumed to be on top of the ICF foundation walls.
 - Openings in the foundation wall must be less than 1 220 mm in width, and the total openings in the wall must be less than 25% of the wall area.
 - When the length of the wall between windows is less than the average length of the windows, the wall is considered to be unsupported and additional engineering is required.
 - Reinforcing bars must be hard-grade deformed bars conforming to CSA G30.18-09, "Carbon Steel Bars for Concrete Reinforcement," Grade 400. The specified yield strength of reinforcement, f_y , is 400 MPa.
 - Wall designs that detail bends, placement, spacing, splicing and protection of reinforcement must be in accordance with CSA A23.3-14, "Design of Concrete Structures."
 - The minimum concrete cover for vertical reinforcement is 35 mm from the inside face (tension face) of concrete.
 - The minimum concrete cover for horizontal reinforcement is 25 mm from the inside face of concrete.
 - Two 10M bars must be placed around all openings and extend 600 mm (24 in.) beyond each side of the openings.
 - There shall be a minimum 28-day concrete yield strength of 20 MPa. Mix designs in accordance with the manufacturer's recommendations.
 - There shall be a minimum 4% to 7% concrete air entrainment when exposed to freeze/thaw cycles.
 - The concrete must be allowed to cure for a minimum of 7 days prior to backfilling.
 - Below-grade walls must be supported by the floor system at the top.
 - All materials and workmanship must conform to the requirements of the NBC 2015, including any Revisions and Errata that have been released as of the issue date of this table.
- 2 Table cells without a value indicate that the spacing is not feasible with respect to the proposed backfill height.

Table 2. Vertical and horizontal steel reinforcement for above-grade walls ⁽¹⁾

Wall height (m)	Max. spacing for vertical reinforcement (mm)		Max. spacing for horizontal reinforcement (mm)	
	150-mm wall	200-mm wall	150-mm wall	200-mm wall
Single-storey concrete construction supporting a wood-frame roof structure				
2.44	10M @ 406	10M @ 305	10M @ 419	15M @ 419
3.05	10M @ 406	10M @ 305	10M @ 419	15M @ 419
3.66	10M @ 203	10M @ 305	10M @ 419	15M @ 419

This PDF is an alternative version. This document was published on 2024-02-29 and may not be the latest version of this evaluation. Users should consult the latest [published assessment](#) on the [CCMC Registry of Product Assessments](#), which contains the most up to date information. This PDF is intended for use as a record, not the latest information available.

Ground floor concrete construction supporting a second storey woodframe and wood-frame roof structure				
2.44	10M @ 406	10M @ 305	10M @ 419	15M @ 419
3.05	10M @ 406	10M @ 305	10M @ 419	15M @ 419
3.66	10M @ 203	10M @ 305	10M @ 419	15M @ 419
Ground floor concrete construction supporting a second storey concrete construction and a wood-frame roof structure				
2.44	10M @ 406	10M @ 305	10M @ 419	15M @ 419
3.05	10M @ 406	10M @ 305	10M @ 419	15M @ 419
3.66	10M @ 203	10M @ 305	10M @ 419	15M @ 419

Note

- 1 The "Vertical and horizontal steel reinforcement for above-grade walls" table is based on the following assumptions:
- The design is applicable to seismic zones up to $S_a(0.2) = 1.2$ for Site Class C.
 - Applicable to a maximum wind pressure of $q(1/50) = 1.2$ kPa.
 - For allowable building dimensions and floor and roof clear spans, see Note 1 to [Table 1](#)
 - For assumed loads, see Note 1 to [Table 1](#)
 - For concrete and steel material properties, see Note 1 to [Table 1](#)
 - Above-grade vertical reinforcement is to be placed in the middle third of the wall section.
 - Above-grade horizontal reinforcement is to be placed in the middle third of the wall section.
 - A minimum of two 10M bars should be placed around all openings and must extend at least 600 mm beyond each corner of the opening.

Table 3. (a) Minimum steel reinforcement of 210-mm lintels with a 150-mm core ⁽¹⁾ ⁽²⁾

Opening width (mm)	Factored uniformly distributed load (kN/m)													
	2.0		5.0		10.0		15.0		20.0		25.0		30.0	
	Bottom steel	Stirrup end dist. (mm)	Bottom steel	Stirrup end dist. (mm)	Bottom steel	Stirrup end dist. (mm)	Bottom steel	Stirrup end dist. (mm)	Bottom steel	Stirrup end dist. (mm)	Bottom steel	Stirrup end dist. (mm)	Bottom steel	Stirrup end dist. (mm)
900	1-15M	0	1-15M	0	1-15M	0	1-15M	0	1-15M	0	1-15M	0	1-15M	0
1 500	1-15M	0	1-15M	0	1-15M	300	1-15M	300	1-15M	300	1-15M	300	1-20M	300
2 100	1-15M	0	1-15M	0	1-15M	300	1-20M	300	–	–	–	–	–	–
2 700	1-15M	0	1-15M	0	1-20M	300	–	–	–	–	–	–	–	–
3 300	1-15M	0	1-20M	0	–	–	–	–	–	–	–	–	–	–
3 900	1-15M	0	–	–	–	–	–	–	–	–	–	–	–	–
4 500	1-15M	0	–	–	–	–	–	–	–	–	–	–	–	–
5 100	–	–	–	–	–	–	–	–	–	–	–	–	–	–

Notes

This PDF is an alternative version. This document was published on 2024-02-29 and may not be the latest version of this evaluation. Users should consult the latest [published assessment](#) on the [CCMC Registry of Product Assessments](#), which contains the most up to date information. This PDF is intended for use as a record, not the latest information available.

- 1 Tables (a) to (f) are based on the following assumptions:
- The factored uniformly distributed load includes live and dead loads, not including the weight of the lintel.
 - The minimum height of the lintel is 210 mm for Tables (a) and (d); 419 mm for Tables (b) and (e); and 629 mm for Tables (c) and (f).
 - Stirrups are single-leg fabricated from 10M bars spaced at 100 mm on centre (o.c.) for Tables (a) and (d); 200 mm o.c. for Tables (b) and (e); and 300 mm o.c. for Tables (c) and (f).
 - Lintel reinforcing is located at the bottom of the lintel and projects 320 mm for 15M bars and 430 mm for 20M bars into the lintel support on each side.
 - The specified compressive strength of concrete, @ 28 days f'_c , is 20 MPa.
 - The specified yield strength of reinforcement, f_y , is 400 MPa.
 - A minimum of two 10M bars must be placed around all openings and must extend at least 600 mm beyond each corner of the opening.
- 2 Table cells without a value indicate that engineering input is required.

Table 4. (b) Minimum steel reinforcement of 419-mm-deep lintels with a 150-mm core ⁽¹⁾ ⁽²⁾

Opening width (mm)	Factored uniformly distributed load (kN/m)													
	2.0		5.0		10.0		15.0		20.0		25.0		30.0	
	Bottom steel	Stirrup end dist. (mm)	Bottom steel	Stirrup end dist. (mm)	Bottom steel	Stirrup end dist. (mm)	Bottom steel	Stirrup end dist. (mm)	Bottom steel	Stirrup end dist. (mm)	Bottom steel	Stirrup end dist. (mm)	Bottom steel	Stirrup end dist. (mm)
900	1-15M	0	1-15M	0	1-15M	0	1-15M	0	1-15M	0	1-15M	0	1-15M	0
1 500	1-15M	0	1-15M	0	1-15M	500	1-15M	500	1-15M	500	1-15M	500	1-15M	500
2 100	1-15M	0	1-15M	0	1-15M	500	1-15M	500	1-15M	500	1-15M	500	1-15M	500
2 700	1-15M	0	1-15M	0	1-15M	500	1-15M	500	1-15M	500	1-20M	500	1-20M	500
3 300	1-15M	0	1-15M	0	1-15M	500	1-20M	500	1-20M	500	–	–	–	–
3 900	1-15M	0	1-15M	0	1-20M	500	–	–	–	–	–	–	–	–
4 500	1-15M	0	1-15M	0	1-20M	500	–	–	–	–	–	–	–	–
5 100	1-15M	0	1-15M	0	–	–	–	–	–	–	–	–	–	–

Notes

- 1 Tables (a) to (f) are based on the following assumptions:
- The factored uniformly distributed load includes live and dead loads, not including the weight of the lintel.
 - The minimum height of the lintel is 210 mm for Tables (a) and (d); 419 mm for Tables (b) and (e); and 629 mm for Tables (c) and (f).
 - Stirrups are single-leg fabricated from 10M bars spaced at 100 mm o.c. for Tables (a) and (d); 200 mm o.c. for (b) and (e); and 300 mm o.c. for Tables (c) and (f).
 - Lintel reinforcing is located at the bottom of the lintel and projects 320 mm for 15M bars and 430 mm for 20M bars into the lintel support on each side.
 - The specified compressive strength of concrete, @ 28 days f'_c , is 20 MPa.
 - The specified yield strength of reinforcement, f_y , is 400 MPa.
 - A minimum of two 10M bars must be placed around all openings and must extend at least 600 mm beyond each corner of the opening.
- 2 Table cells without a value indicate that engineering input is required.

Table 5. (c) Minimum steel reinforcement of 629-mm lintels with a 150-mm core ⁽¹⁾ ⁽²⁾

Opening width (mm)	Factored uniformly distributed load (kN/m)													
	2.0		5.0		10.0		15.0		20.0		25.0		30.0	
	Bottom steel	Stirrup end dist. (mm)	Bottom steel	Stirrup end dist. (mm)	Bottom steel	Stirrup end dist. (mm)	Bottom steel	Stirrup end dist. (mm)	Bottom steel	Stirrup end dist. (mm)	Bottom steel	Stirrup end dist. (mm)	Bottom steel	Stirrup end dist. (mm)
900	1-20M	0	1-20M	0	1-20M	0	1-20M	0	1-20M	0	1-20M	0	1-20M	0
1 500	1-20M	0	1-20M	0	1-20M	700	1-20M	700	1-20M	700	1-20M	700	1-20M	700
2 100	1-20M	0	1-20M	0	1-20M	700	1-20M	700	1-20M	700	1-20M	700	1-20M	700
2 700	1-20M	0	1-20M	0	1-20M	700	1-20M	700	1-20M	700	1-20M	700	1-20M	700
3 300	1-20M	0	1-20M	0	1-20M	700	1-20M	700	1-20M	700	1-20M	700	1-20M	700
3 900	1-20M	0	1-20M	0	1-20M	700	1-20M	700	1-20M	700	–	–	–	–
4 500	1-20M	0	1-20M	0	1-20M	700	1-20M	700	–	–	–	–	–	–
5 100	1-20M	0	1-20M	0	1-20M	700	–	–	–	–	–	–	–	–

Notes

- 1 Tables (a) to (f) are based on the following assumptions:
- The factored uniformly distributed load includes live and dead loads, not including the weight of the lintel.
 - The minimum height of the lintel is 210 mm for Tables (a) and (d); 419 mm for Tables (b) and (e); and 629 mm for Tables (c) and (f).
 - Stirrups are single-leg fabricated from 10M bars spaced at 100 mm o.c. for Tables (a) and (d); 200 mm o.c. for Tables (b) and (e); and 300 mm o.c. for Tables (c) and (f).
 - Lintel reinforcing is located at the bottom of the lintel and projects 320 mm for 15M bars and 430 mm for 20M bars into the lintel support on each side.
 - The specified compressive strength of concrete, @ 28 days f'_c , is 20 MPa.
 - The specified yield strength of reinforcement, f_y , is 400 MPa.
 - A minimum of two 10M bars must be placed around all openings and must extend at least 600 mm beyond each corner of the opening.
- 2 Table cells without a value indicate that engineering input is required.

Table 6. (d) Minimum steel reinforcement of 210-mm lintels with a 200-mm core ⁽¹⁾ ⁽²⁾

Opening width (mm)	Factored uniformly distributed load (kN/m)													
	2.0		5.0		10.0		15.0		20.0		25.0		30.0	
	Bottom steel	Stirrup end dist. (mm)	Bottom steel	Stirrup end dist. (mm)	Bottom steel	Stirrup end dist. (mm)	Bottom steel	Stirrup end dist. (mm)	Bottom steel	Stirrup end dist. (mm)	Bottom steel	Stirrup end dist. (mm)	Bottom steel	Stirrup end dist. (mm)
900	1-15M	0	1-15M	0	1-15M	0	1-15M	0	1-15M	0	1-15M	0	1-15M	0

This PDF is an alternative version. This document was published on 2024-02-29 and may not be the latest version of this evaluation. Users should consult the latest [published assessment](#) on the [CCMC Registry of Product Assessments](#), which contains the most up to date information. This PDF is intended for use as a record, not the latest information available.

1 500	1-15M	0	1-15M	0	1-15M	300	1-15M	300	1-15M	300	1-15M	300	1-20M	300
2 100	1-15M	0	1-15M	0	1-15M	300	1-20M	300	–	–	–	–	–	–
2 700	1-15M	0	1-15M	0	1-20M	300	–	–	–	–	–	–	–	–
3 300	1-15M	0	1-20M	0	–	–	–	–	–	–	–	–	–	–
3 900	1-15M	0	–	–	–	–	–	–	–	–	–	–	–	–
4 500	1-20M	0	–	–	–	–	–	–	–	–	–	–	–	–
5 100	1-20M	0	–	–	–	–	–	–	–	–	–	–	–	–

Notes

- 1 Tables (a) to (f) are based on the following assumptions:
- The factored uniformly distributed load includes live and dead loads, not including the weight of the lintel.
 - The minimum height of the lintel is 210 mm for Tables (a) and (d); 419 mm for Tables (b) and (e); and 629 mm for Tables (c) and (f).
 - Stirrups are single-leg fabricated from 10M bars spaced at 100 mm o.c. for Tables (a) and (d); 200 mm o.c. for Tables (b) and (e); and 300 mm o.c. for Tables (c) and (f).
 - Lintel reinforcing is located at the bottom of the lintel and projects 320 mm for 15M bars and 430 mm for 20M bars into the lintel support on each side.
 - The specified compressive strength of concrete, @ 28 days f'_c , is 20 MPa.
 - The specified yield strength of reinforcement, f_y , is 400 MPa.
 - A minimum of two 10M bars must be placed around all openings and must extend at least 600 mm beyond each corner of the opening.
- 2 Table cells without a value indicate that engineering input is required.

Table 7. (e) Minimum steel reinforcement of 419-mm lintels with a 200-mm core ⁽¹⁾ ⁽²⁾

Opening width (mm)	Factored uniformly distributed load (kN/m)													
	2.0		5.0		10.0		15.0		20.0		25.0		30.0	
	Bottom steel	Stirrup end dist. (mm)	Bottom steel	Stirrup end dist. (mm)	Bottom steel	Stirrup end dist. (mm)	Bottom steel	Stirrup end dist. (mm)	Bottom steel	Stirrup end dist. (mm)	Bottom steel	Stirrup end dist. (mm)	Bottom steel	Stirrup end dist. (mm)
900	1-15M	0	1-15M	0	1-15M	0	1-15M	0	1-15M	0	1-15M	0	1-15M	0
1 500	1-15M	0	1-15M	0	1-15M	500	1-15M	500	1-15M	500	1-15M	500	1-15M	500
2 100	1-15M	0	1-15M	0	1-15M	500	1-15M	500	1-15M	500	1-15M	500	1-15M	500
2 700	1-15M	0	1-15M	0	1-15M	500	1-15M	500	1-15M	500	1-20M	500	1-20M	500
3 300	1-15M	0	1-15M	0	1-15M	500	1-20M	500	1-20M	500	–	–	–	–
3 900	1-15M	0	1-15M	0	1-20M	500	–	–	–	–	–	–	–	–
4 500	1-15M	0	1-15M	0	1-20M	500	–	–	–	–	–	–	–	–
5 100	1-15M	0	1-20M	0	–	–	–	–	–	–	–	–	–	–

Notes

This PDF is an alternative version. This document was published on 2024-02-29 and may not be the latest version of this evaluation. Users should consult the latest [published assessment](#) on the [CCMC Registry of Product Assessments](#), which contains the most up to date information. This PDF is intended for use as a record, not the latest information available.

- 1 Tables (a) to (f) are based on the following assumptions:
- The factored uniformly distributed load includes live and dead loads, not including the weight of the lintel.
 - The minimum height of the lintel is 210 mm for Tables (a) and (d); 419 mm for Tables (b) and (e); and 629 mm for Tables (c) and (f).
 - Stirrups are single-leg fabricated from 10M bars spaced at 100 mm o.c. for Tables (a) and (d); 200 mm o.c. for Tables (b) and (e); and 300 mm o.c. for Tables (c) and (f).
 - Lintel reinforcing is located at the bottom of the lintel and projects 320 mm for 15M bars and 430 mm for 20M bars into the lintel support on each side.
 - The specified compressive strength of concrete, @ 28 days f'_c , is 20 MPa.
 - The specified yield strength of reinforcement, f_y , is 400 MPa.
 - A minimum of two 10M bars must be placed around all openings and must extend at least 600 mm beyond each corner of the opening.
- 2 Table cells without a value indicate that engineering input is required.

Table 8. (f) Minimum steel reinforcement of 629-mm lintels with a 200-mm core (1) (2)

Opening width (mm)	Factored uniformly distributed load (kN/m)													
	2.0		5.0		10.0		15.0		20.0		25.0		30.0	
	Bottom steel	Stirrup end dist. (mm)	Bottom steel	Stirrup end dist. (mm)	Bottom steel	Stirrup end dist. (mm)	Bottom steel	Stirrup end dist. (mm)	Bottom steel	Stirrup end dist. (mm)	Bottom steel	Stirrup end dist. (mm)	Bottom steel	Stirrup end dist. (mm)
900	1-20M	0	1-20M	0	1-20M	0	1-20M	0	1-20M	0	1-20M	0	1-20M	0
1 500	1-20M	0	1-20M	0	1-20M	700	1-20M	700	1-20M	700	1-20M	700	1-20M	700
2 100	1-20M	0	1-20M	0	1-20M	700	1-20M	700	1-20M	700	1-20M	700	1-20M	700
2 700	1-20M	0	1-20M	0	1-20M	700	1-20M	700	1-20M	700	1-20M	700	1-20M	700
3 300	1-20M	0	1-20M	0	1-20M	700	1-20M	700	1-20M	700	1-20M	700	1-20M	700
3 900	1-20M	0	1-20M	0	1-20M	700	1-20M	700	1-20M	700	–	–	–	–
4 500	1-20M	0	1-20M	0	1-20M	700	1-20M	700	–	–	–	–	–	–
5 100	1-20M	0	1-20M	0	1-20M	700	–	–	–	–	–	–	–	–

Notes

- 1 Tables (a) to (f) are based on the following assumptions:
- The factored uniformly distributed load includes live and dead loads, not including the weight of the lintel.
 - The minimum height of the lintel is 210 mm for Tables (a) and (d); 419 mm for Tables (b) and (e); and 629 mm for Tables (c) and (f).
 - Stirrups are single-leg fabricated from 10M bars spaced at 100 mm o.c. for Tables (a) and (d); 200 mm o.c. for Tables (b) and (e); and 300 mm o.c. for Tables (c) and (f).
 - Lintel reinforcing is located at the bottom of the lintel and projects 320 mm for 15M bars and 430 mm for 20M bars into the lintel support on each side.
 - The specified compressive strength of concrete, @ 28 days f'_c , is 20 MPa.
 - The specified yield strength of reinforcement, f_y , is 400 MPa.
 - A minimum of two 10M bars must be placed around all openings and must extend at least 600 mm beyond each corner of the opening.
- 2 Table cells without a value indicate that engineering input is required.

Table 9. (a) Minimum solid shear wall length for wind pressure equal to 0.4 kPa ⁽¹⁾

Width (m)	Length (m)	150-mm-thick wall (mm)				200-mm-thick wall (mm)			
		2 nd floor		1 st floor of 2 storey		2 nd floor		1 st floor of 2 storey	
		Short dir.	Long dir.	Short dir.	Long dir.	Short dir.	Long dir.	Short dir.	Long dir.
6.1	6.1	1.22	1.22	1.22	1.22	1.22	1.22	1.22	1.22
	12.2	1.22	1.22	1.22	1.22	1.22	1.22	1.22	1.22
	18.3	1.22	1.22	1.26	1.22	1.22	1.22	1.22	1.22
	24.4	1.22	1.22	1.67	1.22	1.22	1.22	1.26	1.22
12.2	6.1	1.22	1.22	1.22	1.22	1.22	1.22	1.22	1.22
	12.2	1.22	1.22	1.22	1.22	1.22	1.22	1.22	1.22
	18.3	1.22	1.22	1.53	1.22	1.22	1.22	1.22	1.22
	24.4	1.39	1.22	2.02	1.22	1.22	1.22	1.53	1.22

Note

- ¹ Tables (a) to (e) are based on the following assumptions:
- The minimum solid wall length is for each side.
 - Roof slope from flat to maximum 1:1.
 - Maximum wall height is 3.66 m for each floor.
 - Linear interpolation is permitted between hourly wind pressures and building dimensions.
 - Specified compressive strength of concrete, @ 28 days f'_c , is 20 MPa.
 - Specified yield strength of reinforcement, f_y , is 400 MPa.

Table 10. (b) Minimum solid shear wall length for wind pressure equal to 0.6 kPa ⁽¹⁾

Width (m)	Length (m)	150-mm-thick wall (mm)				200-mm-thick wall (mm)			
		2 nd floor		1 st floor of 2 storey		2 nd floor		1 st floor of 2 storey	
		Short dir.	Long dir.	Short dir.	Long dir.	Short dir.	Long dir.	Short dir.	Long dir.
6.1	6.1	1.22	1.22	1.22	1.22	1.22	1.22	1.22	1.22
	12.2	1.22	1.22	1.26	1.22	1.22	1.22	1.22	1.22
	18.3	1.22	1.22	1.87	1.22	1.22	1.22	1.41	1.22
	24.4	1.53	1.22	2.48	1.22	1.22	1.22	1.87	1.22
12.2	6.1	1.22	1.22	1.22	1.22	1.22	1.22	1.22	1.22
	12.2	1.22	1.22	1.53	1.22	1.22	1.22	1.22	1.22
	18.3	1.55	1.22	2.27	1.22	1.22	1.22	1.71	1.22
	18.3	2.06	1.22	3.01	1.22	1.55	1.22	2.27	1.22

This PDF is an alternative version. This document was published on 2024-02-29 and may not be the latest version of this evaluation. Users should consult the latest [published assessment](#) on the [CCMC Registry of Product Assessments](#), which contains the most up to date information. This PDF is intended for use as a record, not the latest information available.

Note

- 1 Tables (a) to (e) are based on the following assumptions:
- The minimum solid wall length is for each side.
 - Roof slope from flat to maximum 1:1.
 - Maximum wall height is 3.66 m for each floor.
 - Linear interpolation is permitted between hourly wind pressures and building dimensions.
 - Specified compressive strength of concrete, @ 28 days f'_c , is 20 MPa.
 - Specified yield strength of reinforcement, f_y , is 400 MPa.

Table 11. (c) Minimum solid shear wall length for wind pressure equal to 0.8 kPa ⁽¹⁾

Width (m)	Length (m)	150-mm-thick wall (mm)				200 mm-thick wall (mm)			
		2 nd floor		1 st floor of 2 storey		2 nd floor		1 st floor of 2 storey	
		Short dir.	Long dir.	Short dir.	Long dir.	Short dir.	Long dir.	Short dir.	Long dir.
6.1	6.1	1.22	1.22	1.22	1.22	1.22	1.22	1.22	1.22
	12.2	1.22	1.22	1.67	1.22	1.22	1.22	1.26	1.22
	18.3	1.53	1.22	2.48	1.22	1.22	1.22	1.87	1.22
	24.4	2.02	1.22	3.30	1.22	1.53	1.22	2.48	1.22
12.2	6.1	1.22	1.22	1.22	1.34	1.22	1.22	1.22	1.22
	12.2	1.39	1.22	2.02	1.34	1.22	1.22	1.53	1.22
	18.3	2.06	1.22	3.01	1.34	1.55	1.22	2.27	1.22
	24.4	2.73	1.22	4.00	1.34	2.06	1.22	3.01	1.22

Note

- 1 Tables (a) to (e) are based on the following assumptions:
- The minimum solid wall length is for each side.
 - Roof slope from flat to maximum 1:1.
 - Maximum wall height is 3.66 m for each floor.
 - Linear interpolation is permitted between hourly wind pressures and building dimensions.
 - Specified compressive strength of concrete, @ 28 days f'_c , is 20 MPa.
 - Specified yield strength of reinforcement, f_y , is 400 MPa.

Table 12. (d) Minimum solid shear wall length for wind pressure equal to 1.0 kPa ⁽¹⁾

Width (m)	Length (m)	150-mm-thick wall (mm)				200-mm-thick wall (mm)			
		2 nd floor		1 st floor of 2 storey		2 nd floor		1 st floor of 2 storey	
		Short dir.	Long dir.	Short dir.	Long dir.	Short dir.	Long dir.	Short dir.	Long dir.

6.1	6.1	1.22	1.22	1.22	1.22	1.22	1.22	1.22	1.22
	12.2	1.28	1.22	2.08	1.22	1.22	1.22	1.57	1.22
	18.3	1.90	1.22	3.09	1.22	1.43	1.22	2.33	1.22
	24.4	2.52	1.22	4.11	1.22	1.90	1.22	3.09	1.22
12.2	6.1	1.22	1.22	1.28	1.67	1.22	1.22	1.22	1.26
	12.2	1.72	1.22	2.52	1.67	1.30	1.22	1.90	1.26
	18.3	2.56	1.22	3.76	1.67	1.93	1.22	2.83	1.26
	24.4	3.40	1.22	5.00	1.67	2.56	1.22	3.76	1.26

Note

- 1 Tables (a) to (e) are based on the following assumptions:
- The minimum solid wall length is for each side.
 - Roof slope from flat to maximum 1:1.
 - Maximum wall height is 3.66 m for each floor.
 - Linear interpolation is permitted between hourly wind pressures and building dimensions.
 - Specified compressive strength of concrete, @ 28 days f'_c , is 20 MPa.
 - Specified yield strength of reinforcement, f_y , is 400 MPa.

Table 13. (e) Minimum solid shear wall length for wind pressure equal to 1.2 kPa ⁽¹⁾

Width (m)	Length (m)	150-mm-thick wall (mm)				200-mm-thick wall (mm)			
		2 nd floor		1 st floor of 2 storey		2 nd floor		1 st floor of 2 storey	
		Short dir.	Long dir.	Short dir.	Long dir.	Short dir.	Long dir.	Short dir.	Long dir.
6.1	6.1	1.22	1.22	1.26	1.22	1.22	1.22	1.22	1.22
	12.2	1.53	1.22	2.48	1.22	1.22	1.22	1.87	1.22
	18.3	2.27	1.22	3.70	1.22	1.71	1.22	2.79	1.22
	24.4	3.01	1.22	3.70	1.22	2.27	1.22	3.70	1.22
12.2	6.1	1.22	1.31	1.53	2.00	1.22	1.22	1.22	1.51
	12.2	2.06	1.31	3.01	2.00	1.55	1.22	1.22	1.51
	18.3	3.07	1.31	4.50	2.00	2.31	1.22	3.39	1.51
	24.4	4.08	1.31	5.99	2.00	3.07	1.22	4.50	1.51

Note

- 1 Tables (a) to (e) are based on the following assumptions:
- The minimum solid wall length is for each side.
 - Roof slope from flat to maximum 1:1.
 - Maximum wall height is 3.66 m for each floor.
 - Linear interpolation is permitted between hourly wind pressures and building dimensions.
 - Specified compressive strength of concrete, @ 28 days f'_c , is 20 MPa.
 - Specified yield strength of reinforcement, f_y , is 400 MPa.

Table 14. (a) Minimum solid wall length for $S_a(0.2)$ equals 0.4 ⁽¹⁾

Width (m)	Length (m)	150-mm-thick wall (mm)				200-mm-thick wall (mm)			
		2 nd floor		1 st floor of 2 storey		2 nd floor		1 st floor of 2 storey	
		Short dir.	Long dir.	Short dir.	Long dir.	Short dir.	Long dir.	Short dir.	Long dir.
6.1	6.1	1.22	1.22	1.25	1.25	1.22	1.22	1.22	1.22
	12.2	1.22	1.22	1.84	1.97	1.22	1.22	1.60	1.72
	18.3	1.22	1.26	2.43	2.69	1.22	1.22	2.10	2.34
	24.4	1.22	1.59	3.02	3.42	1.22	1.39	2.60	2.96
12.2	6.1	1.22	1.22	2.02	1.88	1.22	1.22	1.80	1.68
	12.2	1.29	1.29	2.61	2.61	1.22	1.22	2.30	2.30
	18.3	1.49	1.62	3.20	3.33	1.33	1.45	2.80	2.92
	24.4	1.69	1.96	3.79	4.05	1.50	1.74	3.30	3.54

Note

- 1 Tables (a) to (e) are based on the following assumptions:
- The minimum solid wall length is for each side.
 - Roof slope from flat to maximum 1:1.
 - The maximum wall height is 3.66 m for each floor.
 - Seismic effects for Site Class C are considered.
 - Linear interpolation is permitted between seismic zones and building dimensions.
 - Brick veneer at a maximum height of 7.32 m is included.
 - Specified compressive strength of concrete, @ 28 days, f'_c , is 20 MPa.
 - Specified yield strength of reinforcement, f_y , is 400 MPa.

Table 15. (b) Minimum solid wall length for $S_a(0.2)$ equals 0.6 ⁽¹⁾

Width (m)	Length (m)	150-mm-thick wall (mm)				200-mm-thick wall (mm)			
		2 nd floor		1 st floor of 2 storey		2 nd floor		1 st floor of 2 storey	
		Short dir.	Long dir.	Short dir.	Long dir.	Short dir.	Long dir.	Short dir.	Long dir.

6.1	6.1	1.22	1.22	1.85	1.85	1.22	1.22	1.62	1.62
	12.2	1.22	1.36	2.73	2.93	1.22	1.22	2.38	2.56
	18.3	1.46	1.86	3.62	4.02	1.28	1.64	3.13	3.49
	24.4	1.76	2.37	4.50	5.11	1.53	2.07	3.88	4.42
12.2	6.1	1.61	1.41	3.00	2.80	1.46	1.28	2.68	2.50
	12.2	1.91	1.91	3.89	3.89	1.72	1.72	3.43	3.43
	18.3	2.21	2.41	4.77	4.98	1.97	2.15	4.18	4.36
	24.4	2.51	2.92	5.66	6.06	2.23	2.59	4.93	5.30

Note

- 1 Tables (a) to (e) are based on the following assumptions:
- The minimum solid wall length is for each side
 - Roof slope from flat to maximum 1:1.
 - The maximum wall height is 3.66 m for each floor.
 - Seismic effects for Site Class C are considered.
 - Linear interpolation is permitted between seismic zones and building dimensions.
 - Brick veneer at a maximum height of 7.32 m is included.
 - Specified compressive strength of concrete, @ 28 days, f'_c , is 20 MPa.
 - Specified yield strength of reinforcement, f_y , is 400 MPa.

Table 16. (c) Minimum solid wall length for $S_a(0.2)$ equals 0.8 ⁽¹⁾

Width (m)	Length (m)	150-mm-thick wall (mm)				200-mm-thick wall (mm)			
		2 nd floor		1 st floor of 2 storey		2 nd floor		1 st floor of 2 storey	
		Short dir.	Long dir.	Short dir.	Long dir.	Short dir.	Long dir.	Short dir.	Long dir.
6.1	6.1	1.22	1.22	2.45	2.45	1.22	1.22	2.15	2.15
	12.2	1.53	1.80	3.63	3.90	1.35	1.59	3.15	3.40
	18.3	1.93	2.47	4.81	5.35	1.69	2.17	4.16	4.64
	24.4	2.34	3.14	5.99	6.80	2.03	2.75	5.16	5.88
12.2	6.1	2.14	1.87	3.99	3.72	1.94	1.70	3.56	3.32
	12.2	2.54	2.54	5.17	5.17	2.28	2.28	4.56	4.56
	18.3	2.94	3.21	6.35	6.62	2.61	2.86	5.56	5.81
	24.4	3.34	3.88	7.53	8.07	2.95	3.44	6.57	7.05

Note

- 1 Tables (a) to (e) are based on the following assumptions:
- The minimum solid wall length is for each side
 - Roof slope from flat to maximum 1:1.
 - The maximum wall height is 3.66 m for each floor.
 - Seismic effects for Site Class C are considered.
 - Linear interpolation is permitted between seismic zones and building dimensions.
 - Brick veneer at a maximum height of 7.32 m is included.
 - Specified compressive strength of concrete, @ 28 days, f'_c , is 20 MPa.
 - Specified yield strength of reinforcement, f_y , is 400 MPa.

Table 17. (d) Minimum solid wall length for $S_a(0.2)$ equals 1.00 ⁽¹⁾

Width (m)	Length (m)	150-mm-thick wall (mm)				200-mm-thick wall (mm)			
		2 nd floor		1 st floor of 2 storey		2 nd floor		1 st floor of 2 storey	
		Short dir.	Long dir.	Short dir.	Long dir.	Short dir.	Long dir.	Short dir.	Long dir.
6.1	6.1	1.41	1.41	3.05	3.05	1.25	1.25	2.68	2.68
	12.2	1.91	2.24	4.53	4.86	1.68	1.98	3.93	4.23
	18.3	2.41	3.08	6.00	6.68	2.10	2.70	5.19	5.79
	24.4	2.91	3.92	7.48	8.49	2.52	3.43	6.44	7.34
12.2	6.1	2.66	2.32	4.98	4.64	2.41	2.11	4.44	4.14
	12.2	3.16	3.16	6.45	6.45	2.83	2.83	5.69	5.69
	18.3	3.66	4.00	7.93	8.27	3.26	3.56	6.95	7.25
	24.4	4.16	4.83	9.40	10.08	3.68	4.28	8.20	8.80

Note

- 1 Tables (a) to (e) are based on the following assumptions:
- The minimum solid wall length is for each side.
 - Roof slope from flat to maximum 1:1.
 - The maximum wall height is 3.66 m for each floor
 - Seismic effects for Site Class C are considered.
 - Linear interpolation is permitted between seismic zones and building dimensions.
 - Brick veneer at a maximum height of 7.32 m is included.
 - Specified compressive strength of concrete, @ 28 days, f'_c , is 20 MPa.
 - Specified yield strength of reinforcement, f_y , is 400 MPa.

Table 18. (e) Minimum solid wall length for $S_a(0.2)$ equals 1.2 ⁽¹⁾

Width (m)	Length (m)	150-mm-thick wall (mm)				200-mm-thick wall (mm)			
		2 nd floor		1 st floor of 2 storey		2 nd floor		1 st floor of 2 storey	
		Short dir.	Long dir.	Short dir.	Long dir.	Short dir.	Long dir.	Short dir.	Long dir.

This PDF is an alternative version. This document was published on 2024-02-29 and may not be the latest version of this evaluation. Users should consult the latest [published assessment](#) on the [CCMC Registry of Product Assessments](#), which contains the most up to date information. This PDF is intended for use as a record, not the latest information available.

6.1	6.1	1.68	1.68	3.66	3.66	1.49	1.49	3.21	3.21
	12.2	2.28	2.68	5.43	5.83	2.00	2.36	4.71	5.07
	18.3	2.88	3.69	7.20	8.00	2.51	3.23	6.22	6.94
	24.4	3.48	4.69	8.97	10.18	3.02	4.10	7.72	8.80
12.2	6.1	3.18	2.78	5.87	5.56	2.88	2.52	5.32	4.96
	12.2	3.78	3.78	7.74	7.74	3.39	3.39	6.82	6.82
	18.3	4.39	4.79	9.51	9.91	3.90	4.26	8.33	8.69
	24.4	4.99	5.79	11.28	12.08	4.41	5.13	9.83	10.55

Note

1 Tables (a) to (e) are based on the following assumptions:

- The minimum solid wall length is for each side.
- Roof slope from flat to maximum 1:1.
- The maximum wall height is 3.66 m for each floor
- Seismic effects for Site Class C are considered.
- Linear interpolation is permitted between seismic zones and building dimensions.
- Brick veneer at a maximum height of 7.32 m is included.
- Specified compressive strength of concrete, @ 28 days, f'_c , is 20 MPa.
- Specified yield strength of reinforcement, f_y , is 400 MPa.

Administrative information

Use of Canadian Construction Materials Centre (CCMC) assessments

This assessment must be read in the context of the entire [CCMC Registry of Product Assessments](#), any applicable building code or by-law requirements, and/or any other regulatory requirements (for example, the [Canada Consumer Product Safety Act](#), the [Canadian Environmental Protection Act](#), etc.).

It is the responsibility of the user to confirm that the assessment they are using is current and has not been withdrawn or superseded by a later version on the [CCMC Registry of Product Assessments](#).

Disclaimer

The National Research Council of Canada (NRC) has evaluated only the characteristics of the specific product described herein. The information and opinions in this evaluation are directed to those who have the appropriate degree of experience to use and apply its contents (such as authorities having jurisdiction, design professionals and specifiers). This evaluation is valid when the product is used as part of permitted construction, respecting all conditions and limitations stated in the evaluation, and in accordance with applicable building codes and by-laws.

This evaluation is provided without representation, warranty or guarantee of any kind, expressed or implied, and the NRC provides no endorsement for any evaluated product. The NRC accepts no responsibility whatsoever arising in any way from any and all use of or reliance on the information contained herein or the use of any evaluated product. The NRC is not undertaking to render professional or other services on behalf of any person or entity nor to perform any duty owed by any person or entity to another person or entity.

Language

Une version française de ce document est disponible.

In the case of any discrepancy between the English and French version of this document, the English version shall prevail.

Copyright

© His Majesty the King in Right of Canada, as represented by the National Research Council of Canada, 2024

All rights reserved. No part of this publication may be reproduced, stored in a retrieval system, or transmitted in any form or by any means, electronic, mechanical, photocopying, recording or otherwise, without the prior written permission of the CCMC.

This PDF is an alternative version. This document was published on 2024-02-29 and may not be the latest version of this evaluation. Users should consult the latest [published assessment](#) on the [CCMC Registry of Product Assessments](#), which contains the most up to date information. This PDF is intended for use as a record, not the latest information available.

CCMC recognition

The Canadian Construction Materials Centre (CCMC) assesses compliance with Canadian building, energy and safety codes. We are the only construction code compliance service supported and operated by the Government of Canada. Trusted by over 6,000 regulators across Canada.

Most Canadian authorities having jurisdiction (AHJs) consider CCMC product assessments acceptable as evidence for product approval.

CCMC assessments are recognized by construction authorities across Canada:

Alliance of Canadian Building Official Associations (ACBOA)



[\(Alliance of Canadian Building Official Associations \(ACBOA\)\)](#)

First Nations National Building Officers Association (FNNBOA)



[\(First Nations National Building Officers Association \(FNNBOA\)\)](#)

Canadian Home Builders' Association (CHBA)



[\(Canadian Home Builders' Association \(CHBA\)\)](#)

Alberta Building Officials Association (ABOA)



[\(Alberta Building Officials Associations \(ABOA\)\)](#)

Saskatchewan Building Officials Association (SBOA)



[\(Saskatchewan Building Officials Association \(SBOA\)\)](#)

Manitoba Building Officials Association (MBOA)



[\(Manitoba Building Officials Association \(MBOA\)\)](#)

Ontario Building Officials Association (OBOA)



[\(Ontario Building Officials Association \(OBOA\)\)](#)

New Brunswick Building Officials Association (NBBOA)



[\(New Brunswick Building Officials Association \(NBBOA\)\)](#)

Nova Scotia Building Officials Association (NSBOA)



[\(Nova Scotia Building Officials Association \(NSBOA\)\)](#)

The CCMC provides code compliance assessments to Canadian code requirements, consulting nationwide with construction regulators to elicit regional variations in code requirements as well as provincial and local interpretations. Users are advised to review the technical information presented in CCMC assessments when making approval decisions. [Learn more about how the CCMC provides a unique service for Canada.](#)

For more information, contact the CCMC by phone at (613) 993-6189 or by email at ccmc@nrc-cnrc.gc.ca

NOTICE

The information presented on this webpage (in HTML format) is the most up-to-date information available from the CCMC about this assessment.

By downloading this PDF you acknowledge that:

- this PDF is intended for record-keeping purposes only,
- it represents the information as it was available at the time of downloading, and
- it may not reflect the latest available information at some future date.

References to this CCMC assessment (in product literature, on websites, etc.) must be made by linking to the evaluation webpage. **This PDF must not be used as a means of distributing this assessment to an audience.**

[View PDF \(Portable document format\)](#)

Code compliance as an acceptable solution

Code Compliance via Acceptable Solutions

If a building design (e.g. material, component, assembly or system) can be shown to meet all provisions of the applicable **acceptable solutions** in Division B (e.g. it complies with the applicable provisions of a referenced standard), it is deemed to have satisfied the objectives and functional statements linked to those provisions and thus to have complied with that part of the Code.

— National Building Code of Canada, Sentence A-1.2.1.1.(1)(a)

The CCMC has determined that compliance with this provision of the Code has been demonstrated as an **Acceptable Solution**. The evaluation report provides a summary of the basis of CCMC's compliance opinion.

CCMC's code compliance opinions

All CCMC evaluation reports are opinions of code compliance established in accordance with the National Building Code of Canada, Subsection 1.2.1. "Compliance with this Code," which requires compliance to be achieved by:

- complying with the applicable acceptable solutions in Division B, or
- using an alternative solution that will achieve at least the minimum level of performance required by Division B in the areas defined by the objective and functional statements attributed to the applicable acceptable solutions.

The CCMC assesses compliance with Canadian building, energy and safety codes, and is trusted by over 6,000 regulators across Canada.

Code compliance as an alternative solution

Code Compliance via Alternative Solutions

Where a design differs from the acceptable solutions in Division B, then it should be treated as an **"alternative solution."** A proponent of an alternative solution must demonstrate that the alternative solution addresses the same issues as the applicable acceptable solutions in Division B and their attributed objectives and functional statements. However, because the objectives and functional statements are entirely qualitative, demonstrating compliance with them in isolation is not possible. Therefore, Clause 1.2.1.1.(1)(b) identifies the principle that Division B establishes the quantitative performance targets that alternative solutions must meet. In many cases, these targets are not defined very precisely by the acceptable solutions [...] Nevertheless, Clause 1.2.1.1.(1)(b) makes it clear that an effort must be made to demonstrate that an alternative solution will perform as well as a design that would satisfy the applicable acceptable solutions in Division B—not “well enough” but “as well as.”

— National Building Code of Canada, Sentence A-1.2.1.1.(1)(b)

The CCMC has determined that compliance with this provision of the Code has been demonstrated as an **Alternative Solution**. The evaluation report provides a summary of the basis of CCMC's compliance opinion.

CCMC's code compliance opinions

All CCMC evaluation reports are opinions of code compliance established in accordance with the National Building Code of Canada, Subsection 1.2.1. "Compliance with this Code," which requires compliance to be achieved by:

- complying with the applicable acceptable solutions in Division B, or
- using an alternative solution that will achieve at least the minimum level of performance required by Division B in the areas defined by the objective and functional statements attributed to the applicable acceptable solutions.

The CCMC assesses compliance with Canadian building, energy and safety codes, and is trusted by over 6,000 regulators across Canada.